



User Manual



---

## BLUETOOTH WIRELESS EARPHONES / NAKAMICHI Uno

---

 [nakamichihomeaudio.com](http://nakamichihomeaudio.com)  [Nakamichi.global](https://www.facebook.com/Nakamichi.global)  [nakamichihomeaudio](https://www.facebook.com/nakamichihomeaudio)  [nakamichihomeaudio](https://www.instagram.com/nakamichihomeaudio)

Connect with us! Explore our social media channels to ask us questions, stay up to date with our latest news and products as well as to register your product warranty online.



## IMPORTANT SAFETY INSTRUCTIONS

---

### For all products

1. Read these instructions.
2. Keep these instructions.
3. Heed all warnings.
4. Follow all instructions.
5. Do not block any ventilation openings. Install this apparatus in accordance with the manufacturer's instructions.
6. Do not install this apparatus near any heat sources such as radiators, heat registers, stoves or other apparatus (including amplifiers) that produce heat.
7. Do not defeat the safety purpose of the polarized or grounding-type plug. A polarized plug has two blades with one wider than the other. A grounding-type plug has two blades and a third grounding prong. The wide blade or the third prong is provided for your safety. If the provided plug does not fit into your outlet, consult an electrician for replacement of the obsolete outlet.
8. Protect the power cord from being walked on or pinched, particularly at plugs, convenience receptacles and the point where they exit from the apparatus.
9. Use only attachments/accessories specified by the manufacturer.
10. Use only with the cart, stand, tripod, bracket or table specified by the manufacturer or sold with the apparatus. When a cart is used, use caution when moving the cart / apparatus combination to avoid injury from tip-over.



11. Unplug this apparatus during lightning storms or when unused for long periods of time.
12. To disconnect this apparatus from the AC mains completely, disconnect the power-supply cord plug from the AC receptacle.
13. The mains plug of the power-supply cord shall remain readily operable.
14. Do not expose batteries to excessive heat such as sunshine, fire or the like.
15. This apparatus is intended to be used only with the power supply and/or charging cable provided by the manufacturer.

#### CAUTION

##### **RISK OF ELECTRIC SHOCK. DO NOT OPEN.**



THE LIGHTNING FLASH WITH AN ARROWHEAD SYMBOL, WITHIN AN EQUILATERAL TRIANGLE, IS INTENDED TO ALERT THE USER TO THE PRESENCE OF UNINSULATED "DANGEROUS VOLTAGE" WITHIN THE PRODUCT'S ENCLOSURE THAT MAY BE OF SUFFICIENT MAGNITUDE TO CONSTITUTE A RISK OF ELECTRIC SHOCK TO PERSONS.



THE EXCLAMATION POINT WITHIN AN EQUILATERAL TRIANGLE IS INTENDED TO ALERT THE USER TO THE PRESENCE OF IMPORTANT OPERATING AND MAINTENANCE (SERVICING) INSTRUCTIONS IN THE LITERATURE ACCOMPANYING THE PRODUCT.

**TWARNING:** TO REDUCETHE RISK OF FIRE OR ELECTRIC SHOCK, DO NOT EXPOSE THIS APPARATUS TO RAIN OR MOISTURE.

---

**CAUTION FCC AND IC STATEMENT FOR USERS  
(USA AND CANADA ONLY)**

This device complies with part 15 of the FCC Rules. Operation is subject to the following two conditions:

- (1) This device may not cause harmful interference,
- (2) This device must accept any interference received, including interference that may cause undesired operation. CAN ICES-3(B)/NMB-3(B)

**Federal Communication Commission Interference Statement**

This equipment has been tested and found to comply with the limits for a Class B digital device, pursuant to Part 15 of the FCC Rules. These limits are designed to provide reasonable protection against harmful interference in a residential installation. This equipment generates, uses and can radiate radio frequency energy and, if not installed and used in accordance with the instructions, may cause harmful interference to radio communications. However, there is no guarantee that interference will not occur in a particular installation. If this equipment does cause harmful interference to radio or television reception, which can be determined by turning the equipment off and on, the user is encouraged to try to correct the interference by one or more of the following measures:

- Reorient or relocate the receiving antenna.
- Increase the separation between the equipment and receiver.
- Connect the equipment into an outlet on a circuit different from that to which the receiver is connected.
- Consult the dealer or an experienced radio/TV technician for help.

---

Caution: Changes or modifications not expressly approved could void the user's authority to operate the equipment.

**For Products That Transmit RF Energy:  
FCC AND IC INFORMATION FOR USERS**

This device complies with Part 15 of the FCC rules and Industry Canada license-exempt RSS standard(s). Operation is subject to the following two conditions:

- (1) This device may not cause harmful interference;
- (2) This device must accept any interference received, including interference that may cause undesired operation.

**FCC/IC Radiation Exposure Statement**

This equipment complies with FCC/IC RSS-102 radiation exposure limits set forth for an uncontrolled environment.

**RoHS Compliance**

This product is in compliance with Directive 2011/65/EU of the European Parliament and of the Council of 8 June 2011 on the restriction of the use of certain hazardous substances in electrical and electronic equipment.

**For Products That Include Batteries  
EU Batteries Directive 2013/56/EU**

A new battery directive 2013/56/EU on Battery and Accumulator replacing directive entered into force on the 01/07/2015. The directive applies to all types

---

of batteries and accumulators (AA, AAA, button cells, lead acid, rechargeable packs) including those incorporated into appliances except for military, medical and power tool applications. The directive sets out rules for collection, treatment, recycling and disposal of batteries, and aims to prohibit certain hazardous substances and to improve environmental performance of batteries and all operators in the supply chain.

### **Instructions for Users on Removal, Recycling and Disposal of Used Batteries**

To remove the batteries from your equipment or remote control, reverse the procedure described in the owner's manual for inserting batteries. For products with a built-in battery that lasts for the lifetime of the product, removal may not be possible for the user. In this case, recycling or recovery centers handle the dismantling of the product and the removal of the battery. If, for any reason, it becomes necessary to replace such a battery, this procedure must be performed by authorized service centers. In the European Union and other locations, it is illegal to dispose of any battery with household trash. All batteries must be disposed of in an environmentally sound manner. Contact your local waste management officials for information regarding the environmentally sound collection, recycling and disposal of used batteries.

---

**WARNING:** Danger of explosion if battery is incorrectly replaced. To reduce risk of fire or burns, don't disassemble, crush, puncture, short external contacts, expose to temperature above 60°C (140 °F), or dispose of in fire or water. Replace only with specified batteries. The symbol indicating 'separate collection' for all batteries and accumulators shall be the crossed-out wheeled bin shown below:



In case of batteries, accumulators and button cells containing more than 0.0005% mercury, more than 0.002% cadmium or more than 0.004% lead, shall be marked with the chemical symbol for the metal concerned: Hg, Cd or Pb respectively. Please Refer to the below symbol:



Hg



Cd



Pb



## **SAFETY WARNINGS**

---

- Thank you for purchasing our product. Please read through this manual before connecting this product to your devices.
- Do also retain this manual for future reference. Do register your warranty on [www.nakamichihomeaudio.com](http://www.nakamichihomeaudio.com)
- Before first use, a full charge is recommended.
- Please use and store the product at room temperature and in a dry place.
- Do not use near any heat sources such as radiators, stoves, or any other apparatus that produce heat.
- Do avoid placing the product near small particles such as sand.
- Do not throw or drop the product to avoid any impact damage
- Please charge the product with the correct voltage at all times.
- Please moderate the volume to avoid any temporary or permanent hearing impairment.
- Do not disassemble the product, there are no user serviceable parts inside. Do not make any modifications to the product. Doing so will void your warranty.
- Please keep the product out of child's reach.
- Do not attempt to replace the battery on your own, please refer to the authorized dealer for any battery replacement.
- Do not expose battery pack to such conditions such as direct sunlight, fire or any similar adverse conditions.

## WHAT'S IN THE BOX

---



Bluetooth Wireless Earphones  
1 Pair

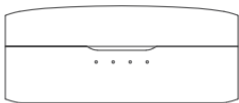

Charging Case  
1 Piece

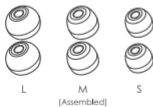

Silicone Ear Tips  
3 Pairs



USB Cable  
1 Piece

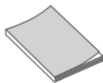

User Manual  
1 Piece

## FIRST TIME USE

---



## POWER OFF

---

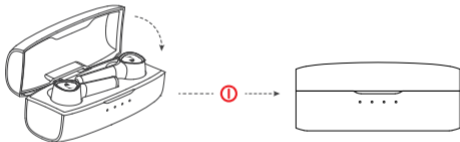

## HOW TO WEAR

---

When wearing the earphones, please note that the hands can only hold the sides of the earphones, and the hands do not press the touching button.

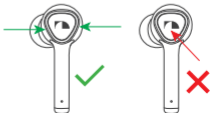

## POWER ON & BLUETOOTH CONNECTION

---

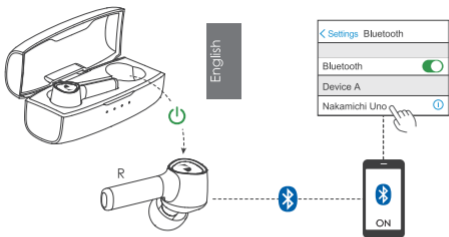

Once removed from the charging case the unit will automatically enter Pairing Mode.

Select "Nakamichi Uno" To Connect

## TWS PAIRING

---

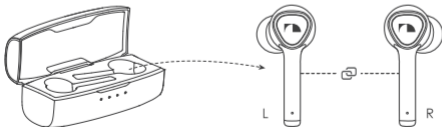

Earphones will automatically pair within 20 seconds.

## MANUAL CONTROLS

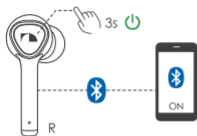

Power ON & Connect To Device

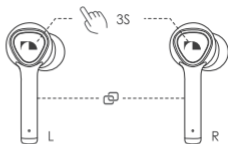

Connecting

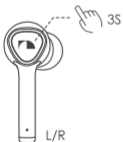

Power ON 

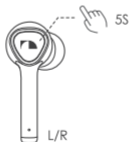

Power OFF 



Reset Pairing

## BUTTON COMMANDS

---

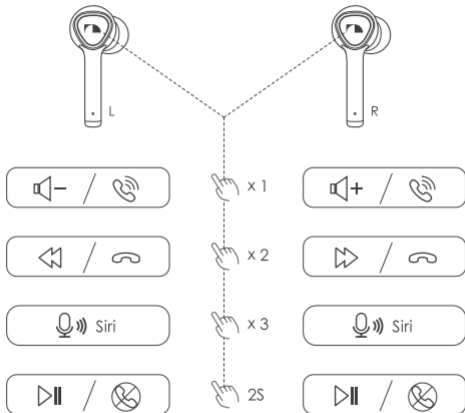

## LED INDICATORS

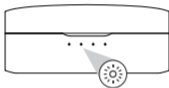
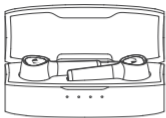

Blinking Blue  
Power On



Blinking Red  
Power Off



Blue light flashes red alternately  
Waiting for Pairing



Blue light flashes slowly  
Paired successfully



25%



50%



75%



100%

## CHARGING

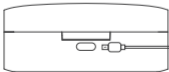

3.7V/400mAh



Charge for approximately 2 hours

## SPECIFICATIONS

---

Driver Unit Size:	φ 7mm
Frequency Response:	20Hz-20KHz
Sensitivity:	92dB
Maximum SPL:	98dB
Microphone Sensitivity:	-42dBv/Pa
Impedance:	16 ohm
Bluetooth Transmitter Power:	5dBm
Bluetooth Frequency:	2.402GHz-2.480GHz
Bluetooth Version:	5.0
Bluetooth Supported Protocol:	HSP/ HFP/ A2DP/ AVRCP/ APTX
Charging Case Input:	DC 5.0V
Charging Case Battery Size:	3.7V, 400mA
Earphones Charging Time :	About 1 hour
Charging Compartment Charging Time :	About 2 hours
Music Playback Time:	About 6 hours
Weight (1pc):	approx. 6.25g





## CONTENIDO DE LA CAJA

---



Auriculares Inalámbricos Bluetooth  
1 par

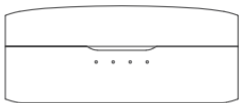

Estuche de carga  
1 pieza

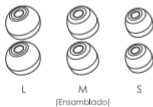

Puntas de oreja de silicona  
3 par

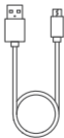

Cable USB  
1 pieza

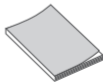

Manual de usuario  
1 pieza

## PRIMER USO

---



## APAGAR

---

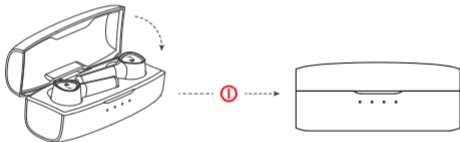

## CÓMO SE LLEVA

---

Cuando use los auriculares, tenga en cuenta que las manos pueden solo sostenga los lados de los auriculares, y las manos no presionan el botón táctil.

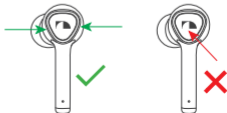

## ENCENDER Y CONECTAR

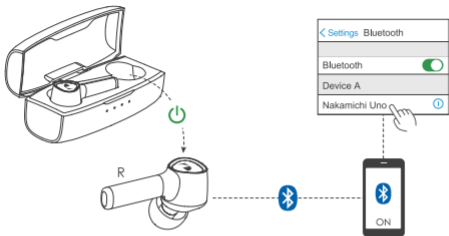

Una vez que se retira del estuche de carga, la unidad ingresará automáticamente al Modo de emparejamiento.

Seleccione "Nakamichi Uno" para conectarse a

## TWS EMPAREJAMIENTO

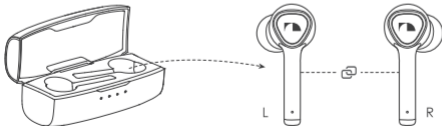

Los auriculares se emparejarán automáticamente en 20 segundos.

## CONTROLES MANUALES

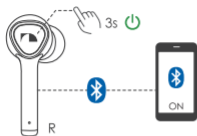

Encender y conectar al dispositivo

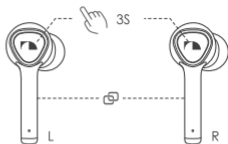

Conectando

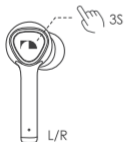

Encendido 

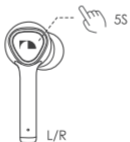

Apagado 



Restablecer  
emparejamiento

## COMANDOS DE BOTONES

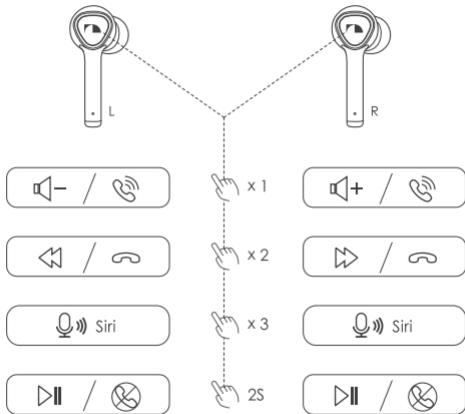

## INDICADORES LED

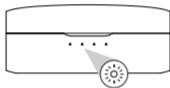
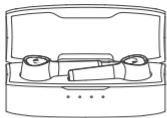

Azul intermitente  
Encendido



Rojo intermitente  
Apagado



La luz azul parpadea en rojo  
alternativamente  
Esperando emparejamiento



La luz azul parpadea lentamente  
Emparejado con éxito



25%



50%



75%



100%

## CARGA

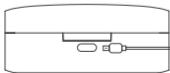

3.7V/400mAh



Carga por aproximadamente 2 horas

## SPECIFICATIONS

---

Tamaño de la unidad del conductor:	φ 7mm
Respuesta frecuente:	20Hz-20KHz
Sensibilidad:	92dB
SPL máximo:	98dB
Sensibilidad del micrófono:	-42dBv/Pa
Impedancia:	16 ohm
Potencia del transmisor Bluetooth:	5dBm
Frecuencia de Bluetooth:	2.402GHz-2.480GHz
Versión de Bluetooth:	5.0
Protocolo compatible con Bluetooth:	HTP/ HSP/ A2DP/ AVRCP/APTX
Entrada de caja de carga:	DC 5.0V
Tamaño de la batería de la caja de carga:	3.7V, 400mA
Tiempo de carga de auriculares:	Aproximadamente 1 hora
Compartimento de carga Tiempo de carga:	Alrededor de 2 horas
Tiempo de reproducción de música:	Cerca de 6 horas
Peso (1 unid):	aprox. 6.25g



## КОМПЛЕКТАЦИЯ

---



Беспроводные наушники  
Bluetooth 1 пара

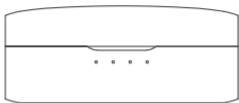

Зарядный футляр  
1 шт

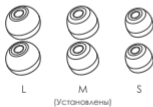

Силиконовые вкладыши  
3 пары



USB-кабель  
1 шт

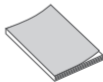

Руководство пользователя  
1 шт

## ПЕРЕД ИСПОЛЬЗОВАНИЕМ

---



## ВЫКЛЮЧЕНИЕ

---

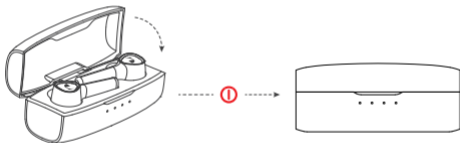

## ИСПОЛЬЗОВАНИЕ

---

Обратите внимание, чтобы надеть, снять или поправить наушники следуете брать за корпус наушников, чтобы не нажать на сенсорную кнопку.



## ВКЛЮЧЕНИЕ И BLUETOOTH СОЕДИНЕНИЕ

---

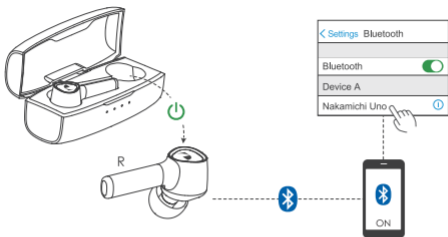

Выберите «Nakamichi Uno» для подключения

## TWS СОЕДИНЕНИЕ

---

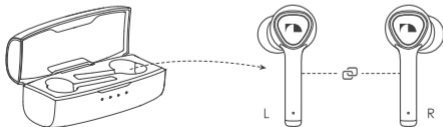

Наушники будут автоматически сопряжены в течение 20 секунд.

## УПРАВЛЕНИЕ

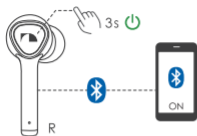

Включение и режим  
сопряжения с устройством

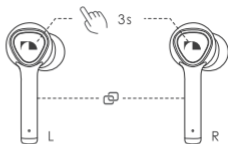

TWS соединение



Включить 

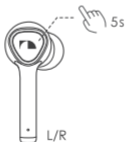

Выключить 

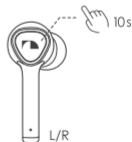

Сбросить сопряжение

## УПРАВЛЕНИЕ

---

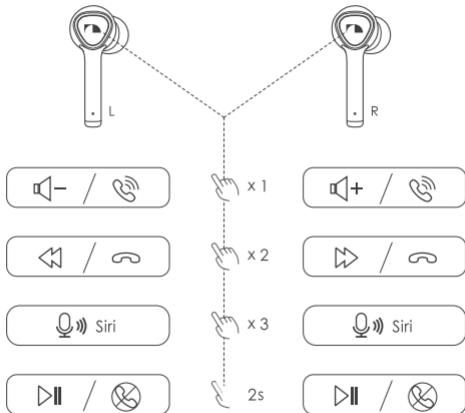

## LED-ИНДИКАТОРЫ

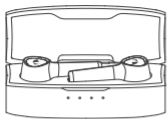

Мигающий синий  
Включение



Мигающий красный  
Выключение



Синий и красный мигают  
попеременно  
Режим сопряжения



Синий мигает редко  
Сопряжено с устройством

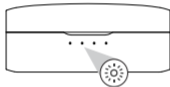

25%



50%



75%



100%



## ЗАРЯДКА

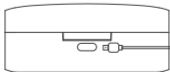

3.7V/400mAh



Зарядка в течение  
примерно 2 часов

## ТЕХНИЧЕСКИЕ ХАРАКТЕРИСТИКИ

---

Размер звукового драйвера	ø 7 мм
Частотный диапазон	20 Hz – 20 kHz
Чувствительность	92 dB
Максимальный SPL	98 dB
Чувствительность микрофона	-42 dBv/Pa
Сопротивление	16 Ohm
Мощность передатчика Bluetooth	5 dBm
Частота Bluetooth	2.40 GHz – 2.48 GHz
Версия Bluetooth	5.0
Протоколы Bluetooth	HFP/HSP/A2DP/AVRCP/APTX
Напряжение заряда футляра	DC 5 V
Встроенный аккумулятор футляра	3.7 V, 400 mA
Время зарядки наушников	≈ 1 час
Время зарядки футляра	≈ 2 часа
Время воспроизведения музыки	≈ 6 часов
Вес (одного наушника)	≈ 6.25 г

## МЕРЫ ПРЕДОСТОРОЖНОСТИ

---

- Используйте устройство только по прямому назначению в соответствии с предоставленной инструкцией.
- Не пытайтесь самостоятельно вскрывать корпус товара и осуществлять ремонт.
- В случае обнаружения недостатков или дефектов, обращайтесь за гарантийным обслуживанием в соответствии с информацией из гарантийного талона.
- Особые условия хранения, реализации и (или) транспортировки не предусмотрены.
- Избегайте воздействия экстремальных температур, длительного воздействия влаги, сильных магнитных полей.
- Устройство предназначено для работы в жилых зонах.
- Срок годности не ограничен при соблюдении условий хранения.
- Пожалуйста, не утилизируйте устройства с литий-ионными аккумуляторами вместе с бытовыми отходами.

## ИНФОРМАЦИЯ О ПРОИЗВОДИТЕЛЕ

---

Торговая марка	Nakamichi
Назначение товара	Пользовательские наушники
Страна происхождения	Китай
Гарантийный период	1 год
Срок службы	2 года
Информация о сервисных центрах:	<a href="http://www.nakamichi.ru">www.nakamichi.ru</a> <a href="http://www.nakamichihomeaudio.com">www.nakamichihomeaudio.com</a>





## 彩盒内物品



蓝牙无线耳机 1对

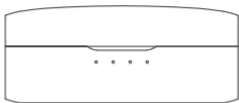

充电盒 1个

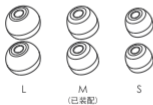

耳塞 3对

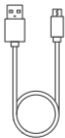

USB线 1条

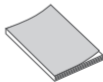

说明书 1本

## 首次使用

---



## 关机

---

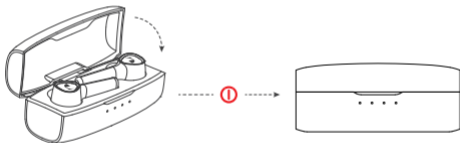

## 如何佩戴

---

佩戴耳机时，  
请注意手只握住耳机的侧面，  
并且手不要触摸按钮。

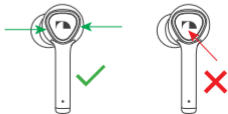

## POWER ON & BLUETOOTH CONNECTION

---

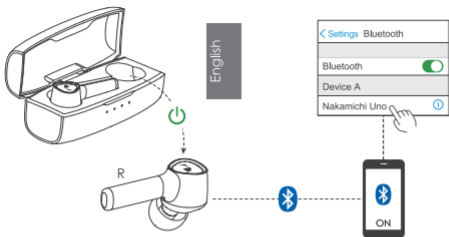

Once removed from the charging case the unit will automatically enter Pairing Mode.

Select "Nakamichi Uno" To Connect

## TWS PAIRING

---

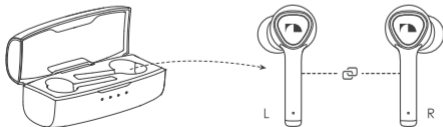

Earphones will automatically pair within 20 seconds.

## 开机和蓝牙连接

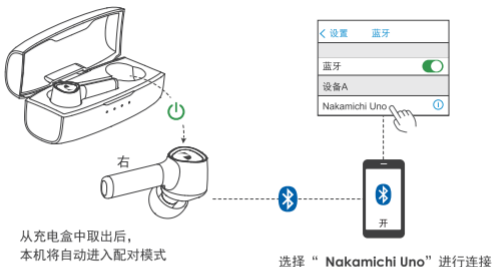

## TWS配对

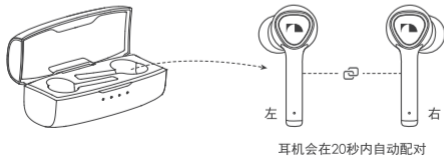

## 手动控制

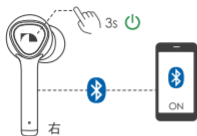

打开电源并连接到设备

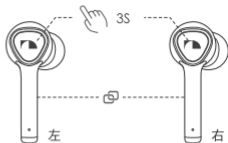

配对连接



开机 



关机 



重新配对

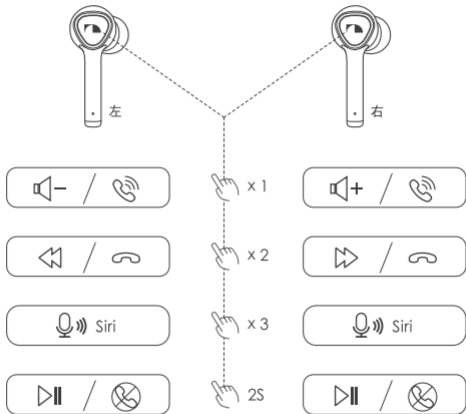

## LED灯显示

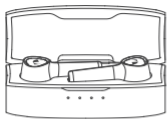

蓝灯闪一下  
开机



红灯闪一下  
关机



蓝灯和红灯交替闪烁  
等待配对中……



蓝灯慢闪  
配对成功

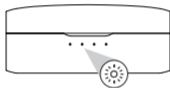

25%



50%



75%



100%

## 产品充电

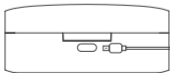

3.7V/400mAh



充电约2小时

## 产品规格

---

驱动单元尺寸:	φ 7mm
频率响应:	20Hz-20KHz
灵敏度:	92dB
最大声压级	98dB
麦克风灵敏度:	-42dBv/Pa
阻抗:	16 ohm
蓝牙发射器电源:	5dBm
蓝牙频率:	2.402GHz-2.480GHz
蓝牙版本:	5.0
蓝牙支持的协议:	HTP/ HSP/ A2DP/ AVRCP/APTX
充电箱输入:	DC 5.0V
充电盒电池尺寸:	3.7V, 400mA
耳机充电时间:	约1小时
充电仓充电时间:	约2小时
音乐播放时间:	约6小时
重量 (1个):	约6.25g





SCAN OUR QR CODE OR VISIT [WWW.NAKAMICHIHOMEAUDIO.COM](http://WWW.NAKAMICHIHOMEAUDIO.COM)

FOR COMPLETE AUDIO SETTINGS INSTRUCTIONS

 Nakamici.Global    nakamichihomeaudio    nakamichihomeaudio

Made in China | 中国制造